

clamp ring with hexagonal nut  
type SH solid, double bolt

[short name: TCKL.MM\\*](#)

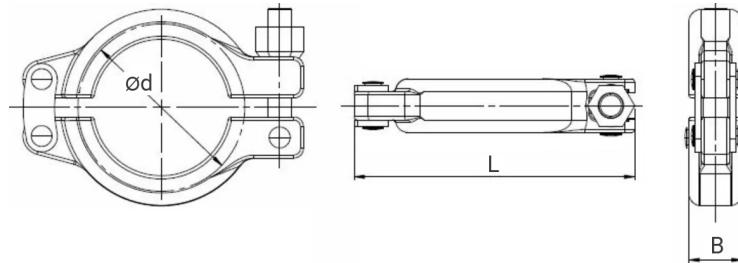

### technical product sheet

DN	DIN-DN	ISO-DN	ASME	d	d3	max	kg	Art.-Nr.
10	10-20	6-10	-	37,0	34	17 bar	0,200	TCKL-010MM
25	25-40	15-25	1"-1,5"	53,0	50,5	17 bar	0,300	TCKL-025MM
50	50	32-40	2"	67,0	64	17 bar	0,400	TCKL-050MM
2,5"	-	50	2,5"	80,0	77,5	17 bar	0,400	TCKL-060MM
65	65	65	3"	94,0	91	17 bar	0,500	TCKL-065MM
80	80	80	-	109,0	106	15 bar	0,500	TCKL-080MM

available material: V2A

Systems > clamp connections > more... > with hexagonal nut

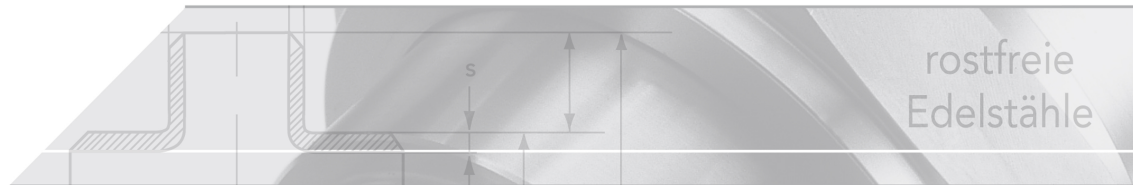

## Clamp connections DIN 32676

### Fields of application

The clamp connections proven in Europe and overseas for many years can be used especially for liquid media, for example for milk, beer, wine, fruit juice, and similar liquids. Popular areas of application are the food, beverage, chemicals, pharmaceuticals, and cosmetics industries as well as in biotechnology, filter technology, and water treatment technology.

### Mounting

During assembly, the clamp seal is placed on one of the two clamp sleeves so that the outer edge of the seal wraps around the flange of the clamp sleeve. Then you place the other clamp sleeve on the seal. The clamp sleeve and the seal are therefore coaxially centered. After that, the clamp is placed around the flange of the clamp sleeve and closed (optionally available with safety lock). The seal deforms in this case so that a smoother passage free of dead space and a sealed connection are created.

